

TITLE 10

SPECIAL ORDINANCES, REGULATIONS, RULES, POLICIES, AND BARGAINING AGREEMENTS

SUBTITLE 5 — SPECIAL ORDERS

SPECIAL ORDER 2

PROHIBITING SKATEBOARDING ON COUNTY PROPERTY

TABLE OF CONTENTS

Section Title

I. Introductory Provisions

1.010 Caption

1.070 Findings section

II. Specific Provisions

1.500 Regulated areas; prohibited activities

III. Miscellaneous Provisions

1.600 Miscellaneous clauses

1.800 Effective date of order

References and Authorities

Legislative History of Policy 30

Appendix 1 — Map of Parking Lot at 6th and Broadalbin

Appendix 2 — Map of Sweet Home Clinic Area

I. Introductory Provisions

2.010 Caption

BEFORE THE BOARD OF COUNTY COMMISSIONERS
FOR LINN COUNTY, OREGON

IN THE MATTER OF REGULATING PREMISES;)
PROHIBITING USE OF SKATEBOARDS AND)
ROLLER SKATES AND BICYCLES)
ORDER

2.070 Findings section

(A) The Board of County Commissioners for Linn County, being advised that damage to public property from unauthorized use of skateboards, roller skates and bicycles has occurred or may be reasonably expected to occur unless controlled, and being further advised that certain areas are damage sensitive including:

(1) The steps and the rectangular concrete structures abutting the steps (hereinafter, the "abutments"), at the main entry to the Linn County Courthouse, being the outside stairway and abutments on the north side of the Courthouse;

(2) Parking lot at Northeast corner of 6th and Broadalbin (area enclosed in heavy black outline in Appendix 1);

(3) Sweet Home Clinic (areas enclosed in heavy black outline in Appendix 2); and being further advised that the potential hazard from unauthorized use of skateboards, roller skates (including in-line roller blades) and bicycles, not only includes public property but also includes persons.

[Adopted 95-364 eff 9/20/95]

II. Specific Provisions

2.500 Regulated areas; prohibited activities

It is hereby ordered, pursuant to authority of ORS 203.023 and LCC 210.100, that the use of

skateboards, roller skates (including in-line roller blades) and bicycles be declared an unauthorized activity and, therefore, be prohibited in the following areas:

(A) Within any public building not designated for and displaying signs allowing such use;

(B) On or against the exterior stairway and its abutments and benches, on the north side of the Linn County Courthouse;

(C) Parking lot at 6th and Broadalbin (area encircled in Appendix 1);

(D) Sweet Home Clinic (area encircled in Appendix 2); except, however, that the use of bicycles as a means of transportation to access, leave or traverse areas designated for transportation is permitted.

(E) It is further ordered that the Linn County General Services Supervisor cause to be posted such signs as is deemed necessary to carry out the purpose of this order.

[Adopted 95-364 eff 9/20/95]

References and Authorities:

ORS 203.023 and LCC 210.100

Legislative History of Policy 30:

Adopted 95-364 eff 9/20/95

Amendments to 95-364:

#1 none

III. Miscellaneous Provisions

2.600 Miscellaneous clauses

It is further ordered that the Linn County General Services Supervisor cause to be posted such signs as is deemed necessary to carry out the purpose of this order.

[Adopted 95-364 eff 9/20/95]

2.800 Effective date of order

September 20, 1995.

[Adopted 95-364 eff 9/20/95]

Appendix 1 — Map of Parking Lot at 6th and Broadalbin

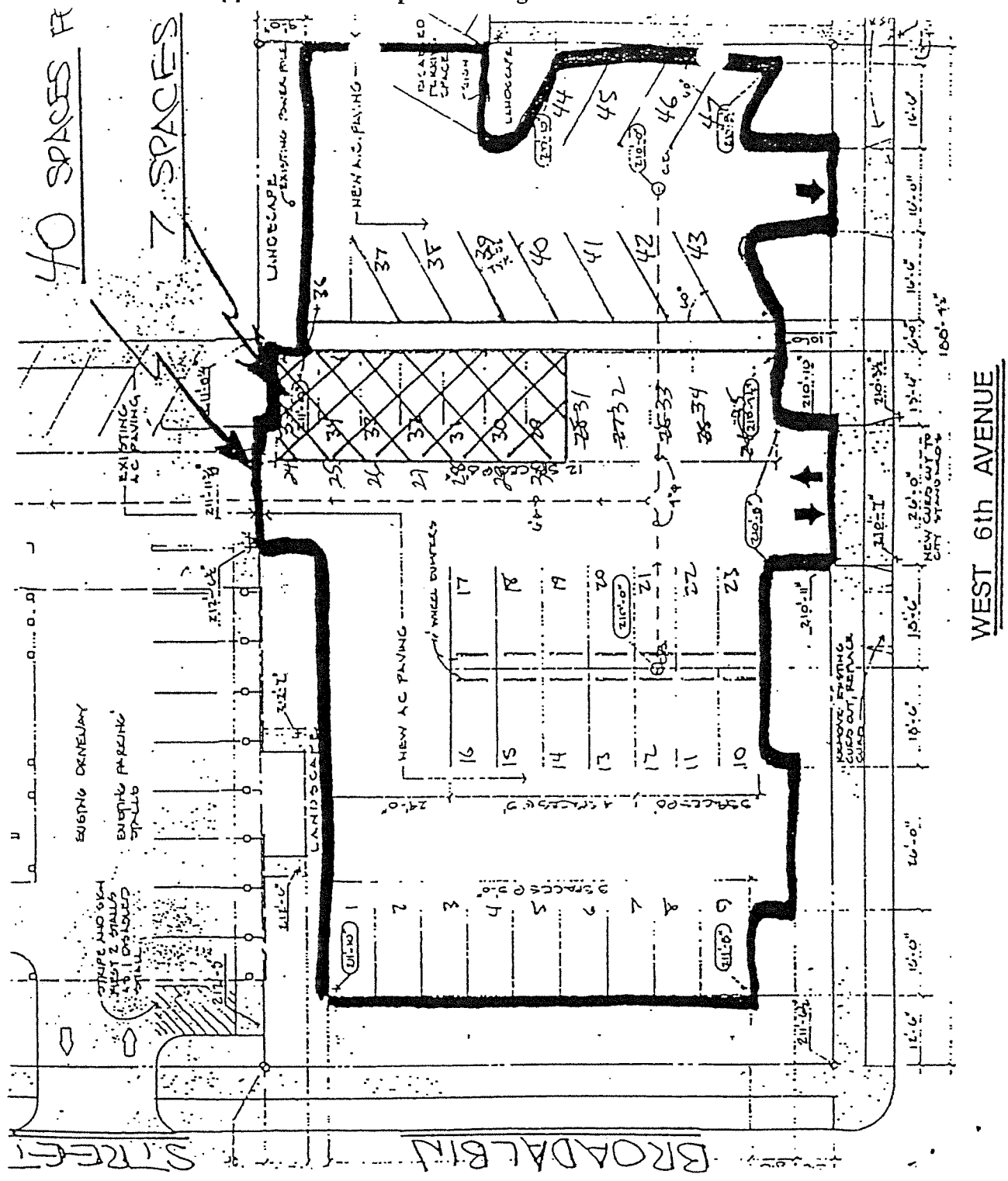

VOL 218 PAGE 255

Exhibit 1

